

附件：达拉特经济开发区区域评估试点范围示意图

内蒙古达拉特经济开发区管理委员会

2021年4月12日



内蒙古达拉特经济开发区党政办公室 2021年4月12日印发

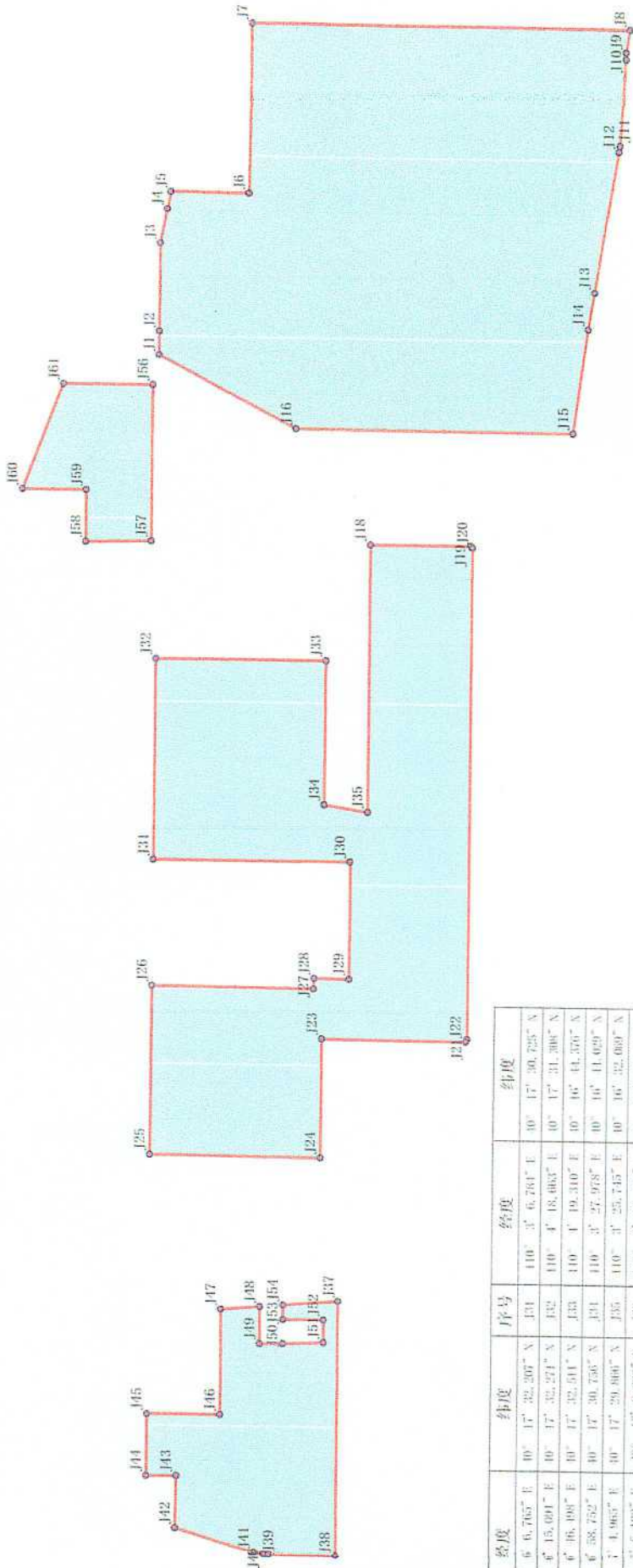

序号	经度	纬度	序号	经度	纬度
J1	110° 6' 5.765" E	00° 17' 32.207" N	J31	110° 3' 4.784" E	00° 17' 30.725" N
J2	110° 6' 15.691" E	00° 17' 32.271" N	J32	110° 3' 18.463" E	00° 17' 31.308" N
J3	110° 6' 46.498" E	00° 17' 32.511" N	J33	110° 1' 19.310" E	00° 16' 44.376" N
J4	110° 6' 38.752" E	00° 17' 30.756" N	J34	110° 3' 27.978" E	00° 16' 44.629" N
J5	110° 7' 4.965" E	00° 17' 29.868" N	J35	110° 3' 25.745" E	00° 16' 32.039" N
J6	110° 7' 5.422" E	00° 17' 8.296" N	J36	110° 0' 30.101" E	00° 16' 37.271" N
J7	110° 8' 4.738" E	00° 17' 8.361" N	J37	110° 0' 30.101" E	00° 16' 37.271" N
J8	110° 8' 5.853" E	00° 17' 24.143" N	J38	109° 58' 58.238" E	00° 16' 36.537" N
J9	110° 7' 57.885" E	00° 15' 25.149" N	J39	109° 58' 58.238" E	00° 16' 36.537" N
J10	110° 7' 55.435" E	00° 15' 25.097" N	J40	109° 58' 58.434" E	00° 16' 56.228" N
J11	110° 7' 25.607" E	00° 15' 26.299" N	J41	109° 58' 59.134" E	00° 16' 56.947" N
J12	110° 7' 23.413" E	00° 15' 26.531" N	J42	109° 59' 7.506" E	00° 17' 20.065" N
J13	110° 6' 32.480" E	00° 15' 32.477" N	J43	109° 59' 25.996" E	00° 17' 20.687" N
J14	110° 6' 19.300" E	00° 15' 34.009" N	J44	109° 59' 25.873" E	00° 17' 28.921" N
J15	110° 5' 42.162" E	00° 15' 37.509" N	J45	109° 59' 47.925" E	00° 17' 29.415" N
J16	110° 5' 11.683" E	00° 16' 51.016" N	J46	109° 58' 48.221" E	00° 17' 9.088" N
J18	110° 5' 0.910" E	00° 16' 32.833" N	J47	110° 0' 20.254" E	00° 17' 9.446" N
J19	110° 5' 1.280" E	00° 16' 5.182" N	J48	110° 0' 27.506" E	00° 16' 58.744" N
J20	110° 5' 0.652" E	00° 16' 4.691" N	J49	110° 0' 14.261" E	00° 16' 58.636" N
J21	110° 5' 5.371" E	00° 16' 3.266" N	J50	110° 0' 14.378" E	00° 16' 52.230" N
J22	110° 5' 4.524" E	00° 16' 3.883" N	J51	110° 0' 15.083" E	00° 16' 41.059" N
J23	110° 5' 4.301" E	00° 16' 12.909" N	J52	110° 0' 23.204" E	00° 16' 41.129" N
J24	110° 5' 21.901" E	00° 16' 43.291" N	J53	110° 0' 23.096" E	00° 16' 52.343" N
J25	110° 5' 20.951" E	00° 17' 29.811" N	J54	110° 5' 56.111" E	00° 17' 33.637" N
J26	110° 5' 22.032" E	00° 17' 30.356" N	J55	110° 5' 0.493" E	00° 17' 33.233" N
J27	110° 5' 21.213" E	00° 16' 45.808" N	J56	110° 5' 59.792" E	00° 17' 51.427" N
J28	110° 5' 25.918" E	00° 16' 45.835" N	J57	110° 5' 18.211" E	00° 17' 51.269" N
J29	110° 5' 25.930" E	00° 16' 36.237" N	J58	110° 5' 17.973" E	00° 18' 8.842" N
J30	110° 5' 7.611" E	00° 16' 36.552" N	J59	110° 5' 55.295" E	00° 17' 38.121" N

